

Add Codon Learning to Your D2L Course

Last Modified on 06/09/2026 3:16 pm CDT

Online Services does not have access to your **Codon Learning** account. For integration issues or questions, please contact your Codon Learning representative, **Jasmine Donkoh**, at jaz@codonlearning.com (). For technical support, please contact support@codonlearning.com ().

This article assumes that your course has already been built in Codon Learning. It is *highly recommended* that you read all steps before performing them.

Codon Learning offers interactive digital course materials primarily designed to support STEM courses (Science, Technology, Engineering, and Mathematics) and integrates with D2L **Brightspace** to support course instruction. This article walks you through the steps to add **Codon Learning** to your D2L course.

ALERT: Codon does not support automatic or scheduled grade transfers to D2L. **Grades must be sent manually.** For manual grade transfer instructions, see the **Syncing Codon Learning Grades to Your D2L Gradebook** section below.

Request Course Integration Access

1. Send an email to VTAC@lonestar.edu ().
2. Include a list of the courses, complete with section numbers and terms, in which you want to use **Codon Learning**.

Adding Codon Learning to a D2L Course

To add **Codon Learning** to your D2L course, follow the steps below.

1. From the **Navbar**, select **[Content]**.

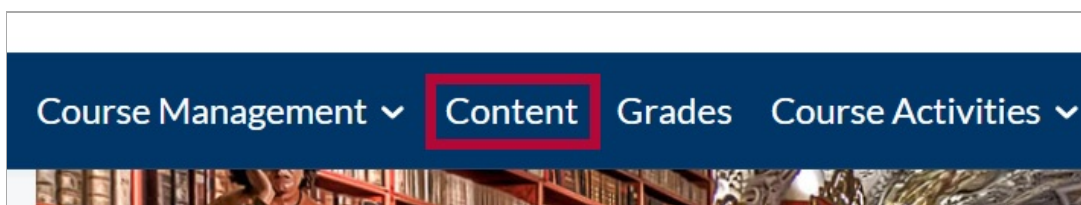

2. Select or create the module where you want to insert your **Codon Learning** content. You can name the module **Codon**.

Overview

Bookmarks

Course Schedule

Table of Contents 56

Getting Started 3

Student Tech Support Recourses

Codon

Codon

Add dates and restrictions...

Add a description...

New

Add Existing Activities

Drag and drop files here

Add a sub-module...

3. From the module, select **[Add Existing Activities]** followed by **[Third-party Integrations]**.

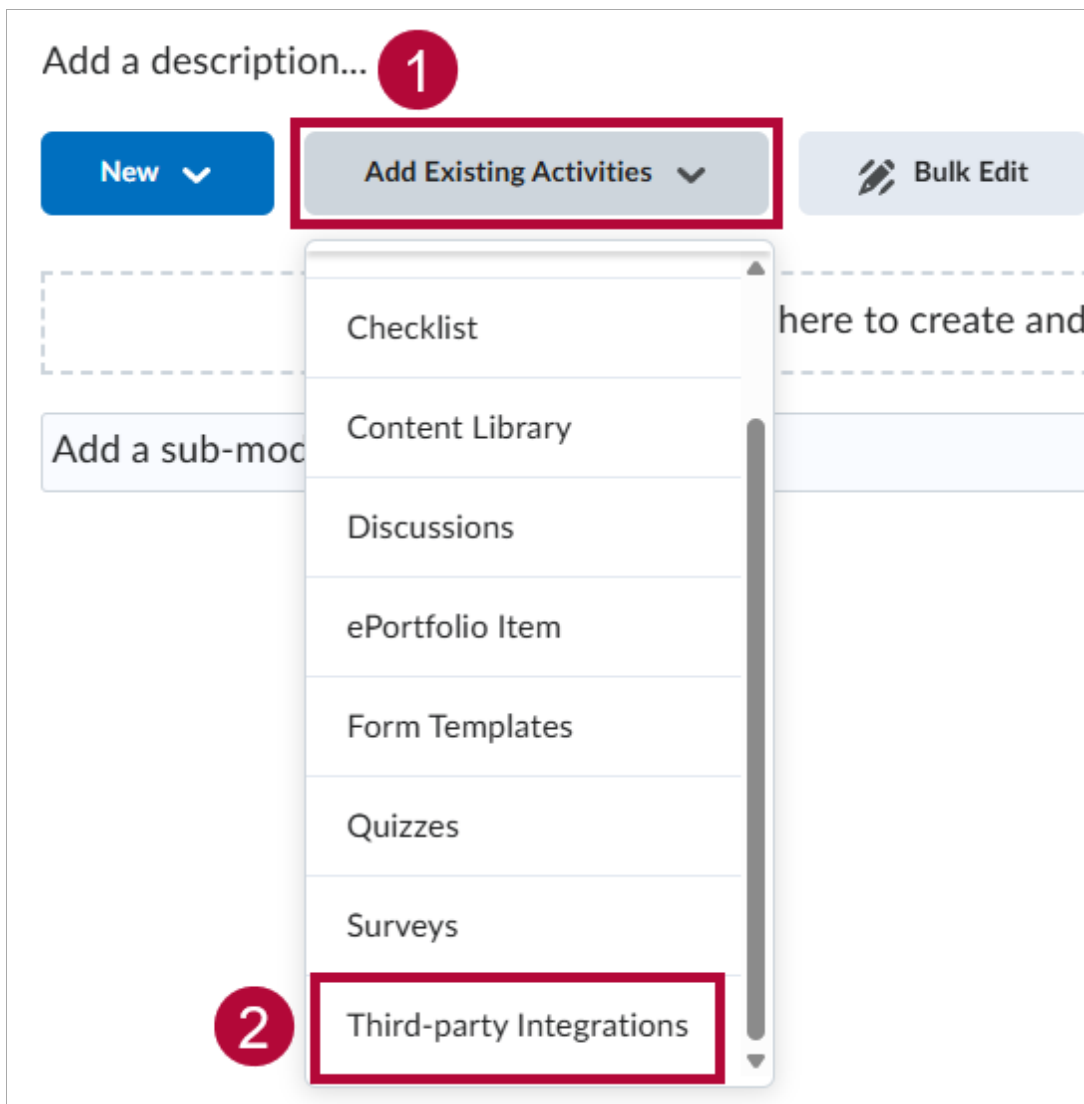

4. From the **Add Activity** window, select **[Codon LTI 1.3]**.

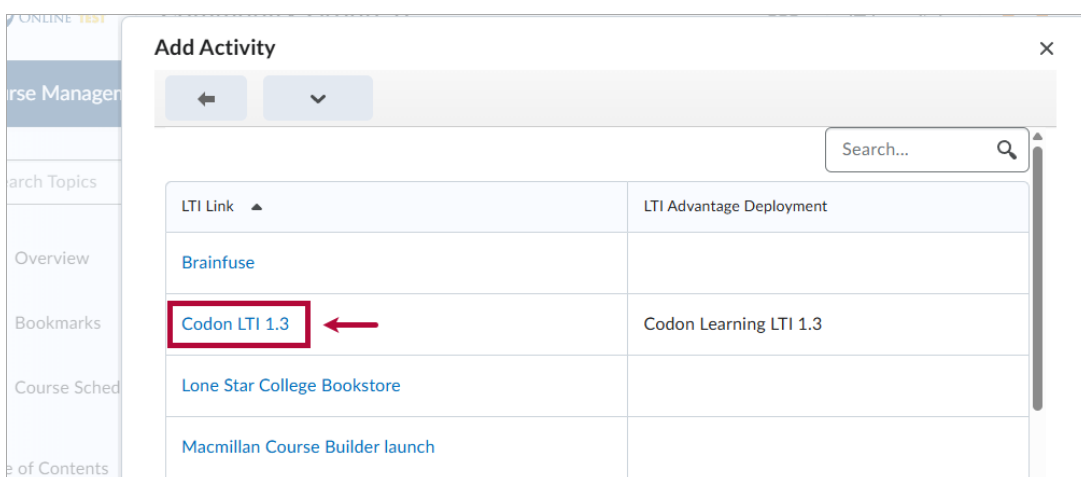

5. The **Codon LTI 1.3** link will appear in the module.

Overview

Bookmarks

Course Schedule

Table of Contents 57

Getting Started 3

Student Tech Support Recourses

Codon 1

Codon

Add dates and restrictions...

Add a description...

New Add Existing Activities

Codon LTI 1.3 Third-party Integration

Add a sub-module...

Linking a Codon Learning Course to a D2L Course

To link your **Codon Learning** course to your D2L course, follow the steps below.

1. Select the [**Codon LTI 1.3**] link you added in the previous steps above.

Overview

Bookmarks

Course Schedule

Table of Contents 57

Getting Started 3

Student Tech Support Recourses

Codon 1

Codon

Add dates and restrictions...

Add a description...

New Add Existing Activities

Codon LTI 1.3 Third-party Integration

Add a sub-module...

2. Select your **Codon Learning** course from the list, then click [**Save Selection**].

Course selector

This is a one-time action required to connect your Learning Management System (LMS) to your Codon Learning course.
Once you have selected your course, click save, close this page, and relaunch from your LMS

1 20251009 - LMS Test Course 2026 (Starts: August 2026)

2

3. On the **Terms of Use for Codon Learning** page, scroll to the bottom and select **[Agree]**.

Upon successful connection from D2L to Codon, you should see the message ***"Please close this page, and relaunch your Codon Learning course from your LMS."***

Contact Us

If you have any questions about these Terms, please contact us at info@codonlearning.com.

> [Show Privacy Policy](#)

> [Show Additional and/or Changed Terms for \[blurred text\]](#)

> [Show Additional and/or Changed Terms for \[blurred text\]](#)

Linking Codon Learning Assessments to a D2L Course

To link your **Codon Learning** course assessments to your D2L course gradebook, follow the steps below.

1. Select **[Codon LTI 1.3]** from the content module.

2. From the Codon course instructor homepage, select the **[Assessments]** tab.

3. From the **Assessments** page, select **[Edit Assessments]**.

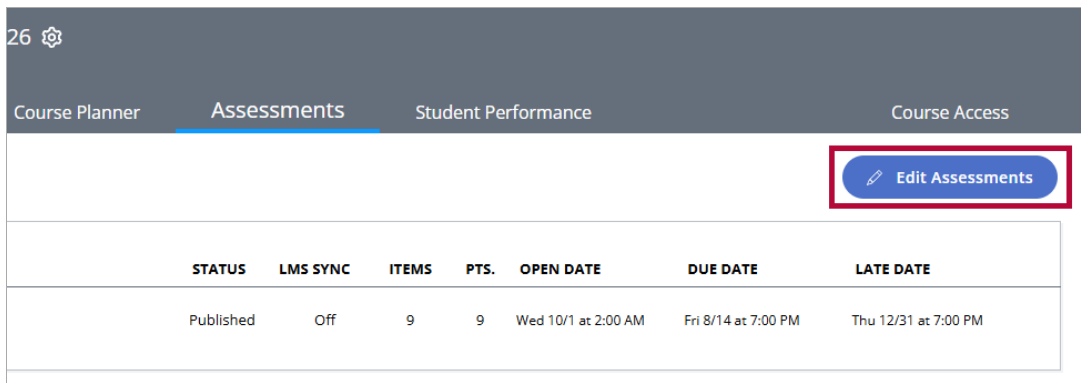

4. Toggle the **LMS SYNC** switch to **[On]** for your assessment(s), then click **[Save]**.

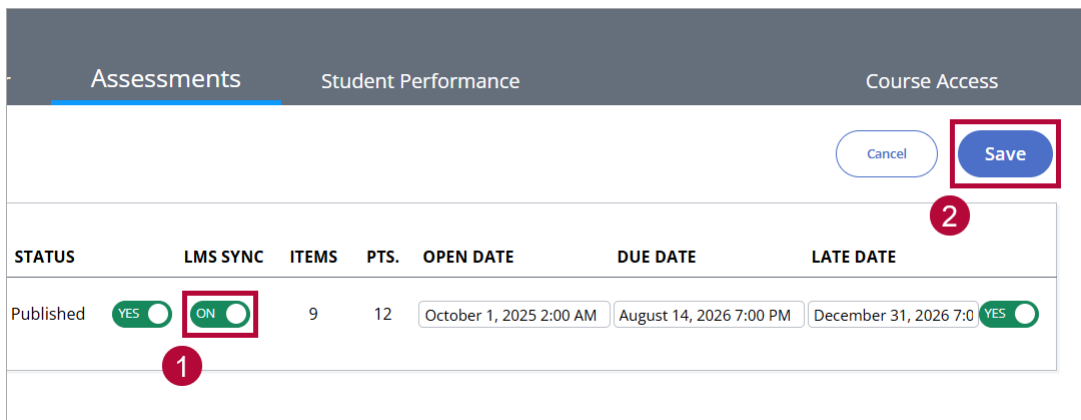

5. Switch back to D2L and navigate to **[Grades]**. You should see a grade item for each of your Codon assignments at the end of your gradebook. You may move or categorize them if needed.

NOTE: If you are using a weighted gradebook, you may change the **weight** amount if needed. The default weight value is **10**.

<input type="checkbox"/>		Numeric	Assignments	100	25
<input type="checkbox"/>		Numeric	Quizzes	100	75
<input type="checkbox"/>	Codon Test Assignment	Numeric	-	9	10
<input type="checkbox"/>	Final Calculated Grade			1,359	110

Syncing Codon Learning Grades to Your D2L Gradebook

Codon does not support automatic or scheduled grade transfers to D2L. **Grades must be sent manually.** To manually send grades from **Codon** to D2L, follow the steps below.

1. Select **[Codon LTI 1.3]** from the content module.

2. From the Codon course instructor homepage, select the **[Student Performance]** tab.

3. From the **Student Performance** page, select **[Go to Score Sync Page]**.

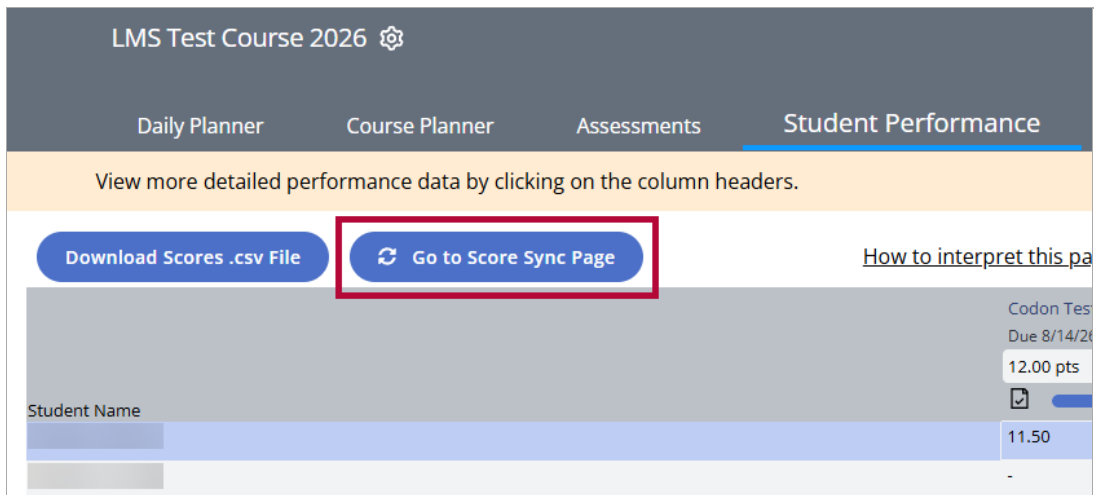

4. From the **Score Sync** page, select one or more assessments from the left list, then click **[Sync Now]**.

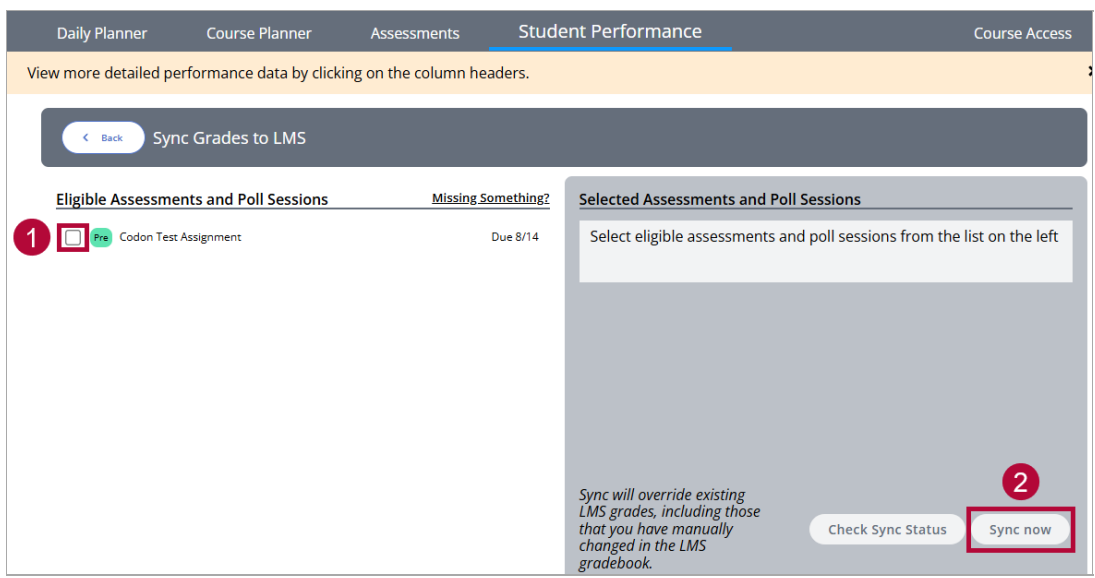

5. Review the warning message, then click **[Sync scores now]** to complete the process.

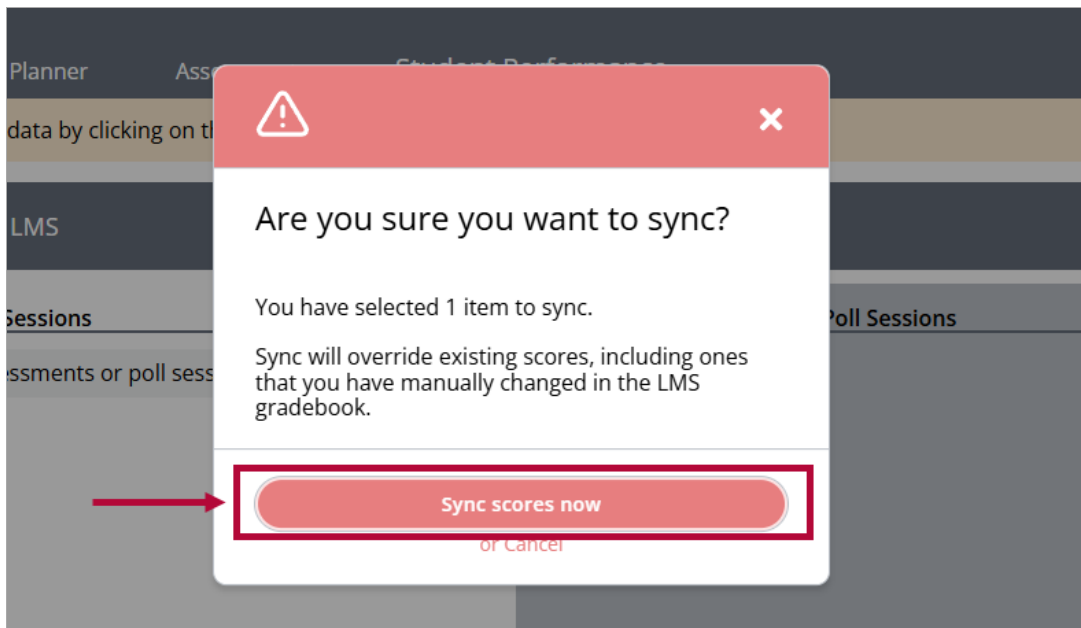

- You may optionally select **[Check Sync Status]** to trigger the **My Grade Sync Activity** table to update and verify grade transfer progress.

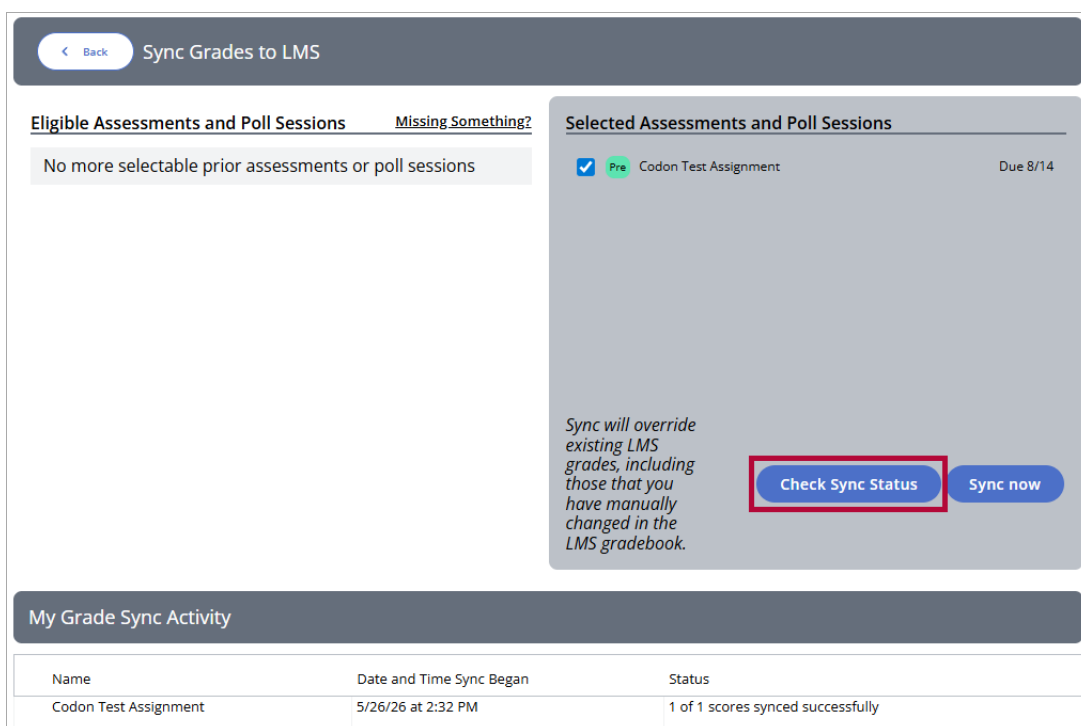

Additional Support Information

- [How to Add or Build a Readiness Reading](https://codonlearning.freshdesk.com/support/solutions/articles/69000838607-how-to-add-or-build-a-readiness-reading)
- [How to Build Pre-Class, In-Class, and Homework Assignments](https://codonlearning.freshdesk.com/support/solutions/articles/69000816360-how-to-build-pre-class-in-class-and-homework-assignments)
- [Codon Learning Instructor Support](https://codonlearning.freshdesk.com/support/solutions/69000402170)

- [Codon Learning Submit a Ticket \(https://codonlearning.freshdesk.com/support/tickets/new\)](https://codonlearning.freshdesk.com/support/tickets/new)